

## Adapter KIT to Power Take Offs

Ref. VK4009AM

ZF

16-S-150 IT

### Main Dimensions

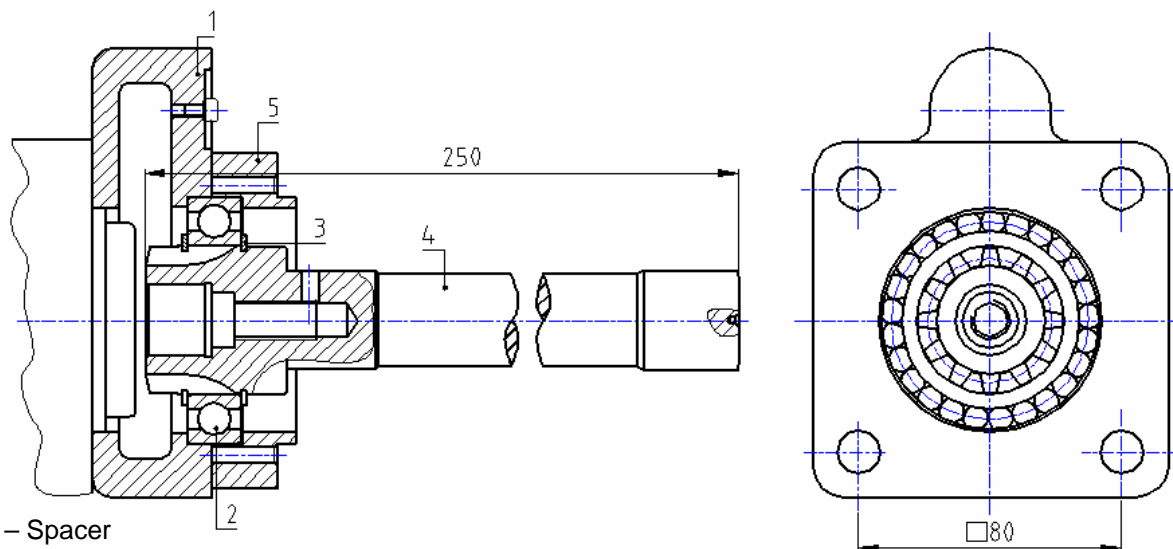

- 1 – Spacer
- 2 – Bearing
- 3 – Circlip
- 4 – Adapter shaft VK 4009
- 5 – Spacer flange

### Main Data

<b>Continuous Torque (Nm)</b>	<b>300</b>
<b>Intermittent Torque (Nm)</b>	<b>420</b>
<b>Power (at 1000 r.p.m)</b>	<b>42 C.V. / 32 Kw</b>
<b>Weight (Kg)</b>	<b>2.5</b>
<b>Engine-Kit adapter ratio</b>	

16-S-150/ 16.47 High: - 1 : 0.920 Normal: - 1 : 0.770  
/ 13.80 High: - 1 : 0.920 Normal: - 1 : 0.770

#### Note 1:

For getting the correct ratio is necessary to multiply the above mentioned ratio by the internal ratio in all S6-90 releases.

#### Example:

Gearbox 16-S-150 / 16.47 / 13.80 Adapter Kit + ZF S6-90 (Ref. TF4002AMP) Internal Ratio 1:1.32

Final ratio: High - 1 : 1.214 (0.92 x 1.32 = 1.214)

Normal - 1 : 1.016 (0.77 x 1.32 = 1.016)

#### KIT Studs:

KIT VK4009AM for PTO (ratio 1:1.32)

- 2 stud M12x155
- 2 stud M12x190
- 4 nut M12
- 4 washer
- 2 jute ZF
- 1 jute IT